

**SITE PLAN KEY:**

-  Pitch
-  Grass Area
-  Games court
-  Hard Play
-  Soft Play
-  Habitat
-  Site Boundary
-  1.2m High Fence
-  2m High Fence
-  4m High Fence
-  Existing trees retained
-  Root protection zone
-  Existing trees removed
-  Existing foliage to be retained where possible, extent to be agreed on site with county landscape architect, Lizard Landscapes, Kier and ECE.

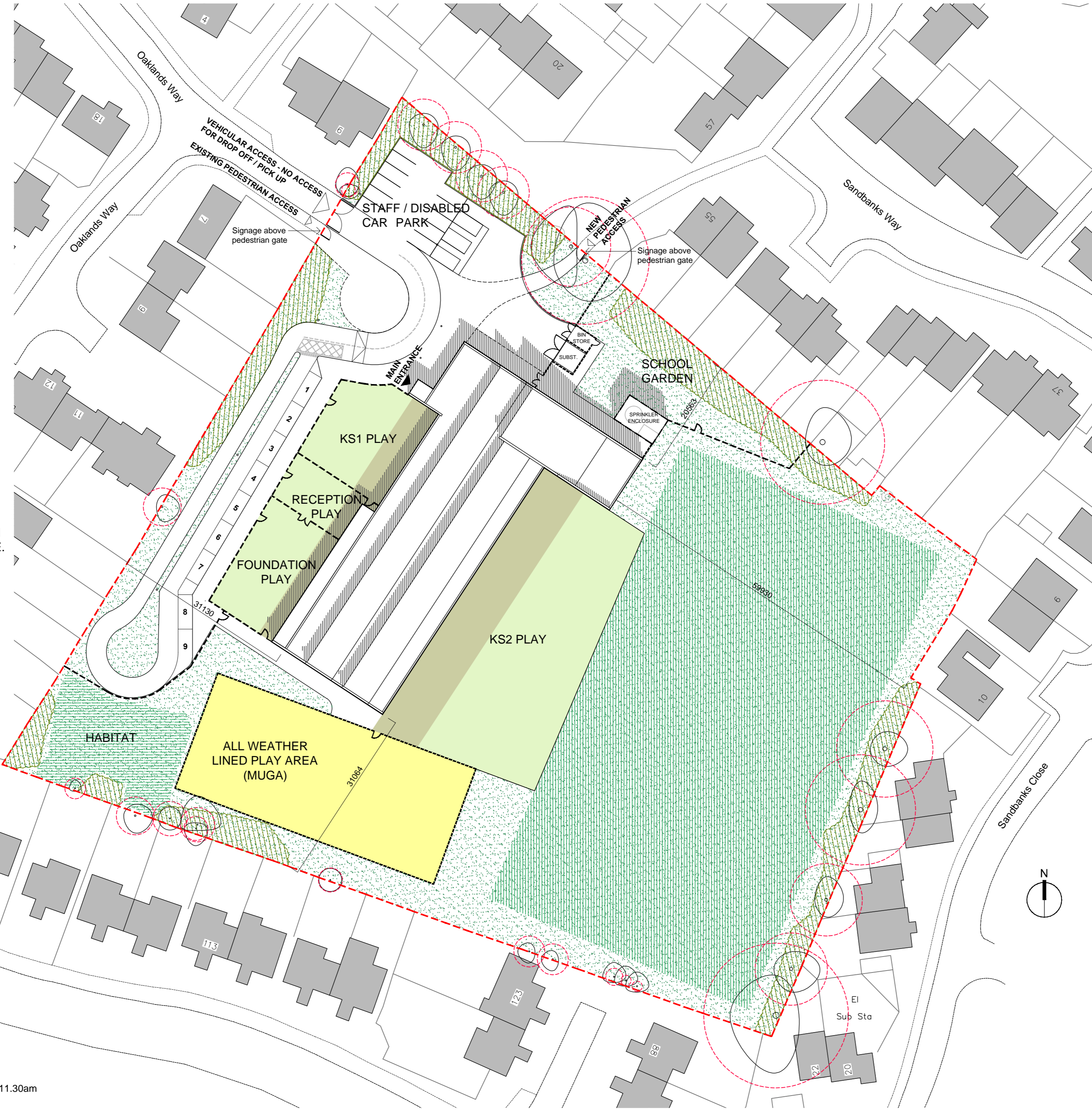

**CDM 2007 Health & Safety Information**

This information relates only to 'Significant Hazards' identified on this drawing and is to be read in conjunction with the Designer's Risk Assessment Register.

Rev	Date	Revision Details	Dr	Ch



LM2.01.02 The Leather Market  
11 - 13 Weston Street  
London  
SE1 3ER  
020 7060 1899 | www.tsurveyors.com

**THOMAS & THOMAS**

Client's Name

**STEP ACADEMY TRUST**

Job Title

**BURFIELD ACADEMY**

Drawing Title

**SITE PLAN**

Scale  
**1:500 @ A2**



Drawn Checked Date

**GC** **08.12.23**

Job No Drawing No Rev  
**23.3341 (PL) 003 A**

Status

Shadows modelled at the vernal equinox at 11.30am